

8-port KM Switch (KM0108)

User Manual



www.kinankvm.com

@all right reserved Shenzhen Kinan Technology Co., Ltd.

Printing date: 2021/09

Version: V1.1

Overview:

Thank you for using our 8-port KM switch, which can effectively save you money, time, space, equipment and energy.

The 8-port KM switch can operate multiple computers at the same time with only one set of keyboard and mouse. Moreover, it supports the use of multi-monitors. Switching between PCs can be easily accomplished. To achieve that, the users only need to connect them to monitors.

Features

- Manage 8 connected computers
- Support stereo audio output
- Support USB2.0 HUB
- Provide LED indicator to help you precisely position your monitors (Optional)
- No software required-switching via front panel buttons and keyboard hotkeys.
- Support hot pluggable-add or remove servers at any time without turning off the power.
- Support USB-C firmware upgrade
- Management software is available to provide customized switching modes (Optional)

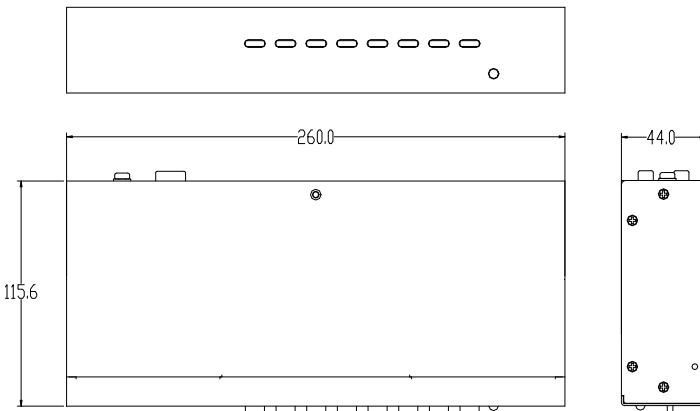
Structure and Size

Installation

Before starting the installation, please make sure that all devices are powered off.

- 1) Ensure that the KM switch (①) is grounded.
- 2) Connect USB keyboard, mouse to the USB interface of KM switch (②)
- 3) Connect the PCs to the KM switch with equipped USB cable (according to ③)
- 4) Plug the power cord into KM switch.(④)
- 5) Power on the computers, switch multiple computers easily trough push buttons and keyboard hotkey [Ctrl]

*** The factory default is no hotkey. It will be activated after pressing [7]+[8] keys 2S on the front panel at the same time.**

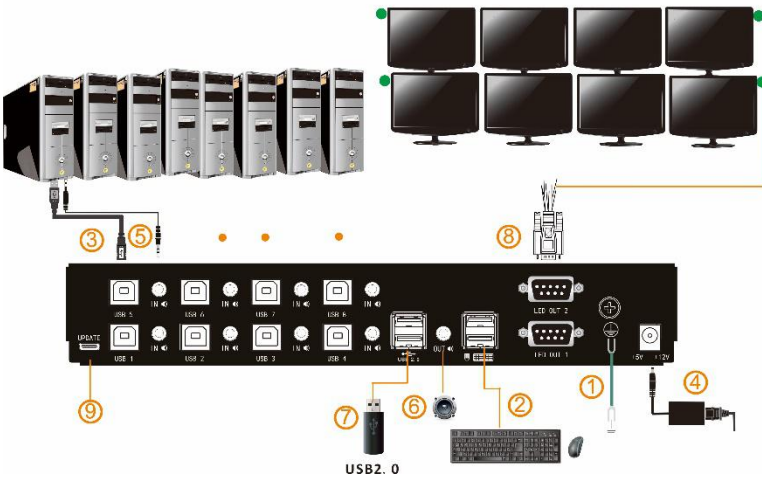

- 6) If speaker is required, please plug in the audio port (⑤⑥)
- 7) If USB2.0 peripherals required, please connect peripherals to USB2.0 port(⑦)

Button

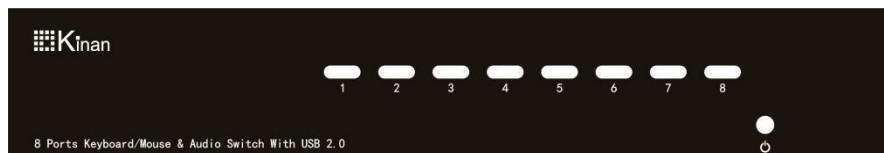

No.	Components	Description
1	1-8	<p>Ports 1 to 8 can be switched freely.</p> <p><i>Pressing [1]+[2] keys for 2S at the same time will cancel the hotkey function.</i></p> <p><i>Pressing [7]+[8] keys for 2S at the same time will activate the hotkey function.</i></p>
2	Port LED	<p>The port LED is built in the port selection buttons. The online LED is on the left and the selected port LED is on the right</p> <p>1) The online LED (green) indicates that the PCs of the corresponding ports have been connected with the KM switch and were powered on.</p> <p>2) The selected LED (orange) indicates that the PCs of the corresponding port are in use.</p>
3	Power Supply LED	When the power LED becomes green, the KM switch is powered on.

Hotkey operation

*** The factory default is no hotkey. To activate hotkey function, please press [7]+[8] keys 2S on the front panel at the same time.**

Press "[L _ Ctrl]" twice+the corresponding key of each function

Command	Hotkey	Description
PC switching	+ 1~8	Switch directly to 1 ~ 8 PCs, for example: Press "L _ ctrl" twice+2, the keyboard and mouse will be switched to the second PC
Mode selection	+ M + 0	Mode selection of all PCs is canceled
	+ M + (1~3)	1. Horizontal KM Switching mode 2. Vertical KM Switching mode 3: Surround KM Switching mode
KM Switching Mode	+ E	The current PC exits the KM Switching mode
	+ S	The current PC(PC single display) is in the KM Switching mode.
	+ D + (0~3)	The current PC(PC multi-display) is in the KM Switching mode, and supports up to 4 displays.
Audio switching	+ A + 0	Unlock the audio (audio automatically follows the KM switching to the corresponding port)
	+ A + (1~8)	Switch and lock the audio separately.
	+ A + O	Mute the audio
HUB switching	+ U + 0	Unlock the USB2.0 (USB2.0 automatically switches to corresponding PC ports with KM)
	+ U + (1~8)	Switch and lock USB 2.0 separately
Broadcast mode	+ B	open or cancel broadcast mode. In broadcast mode, the keyboard and mouse of PCs can be operated synchronously;
Hotkey cycle	+ F	L _ Ctrl -> Scroll -> L _ Shift -> CapsLock ->L _ Alt->NumLock-> F12
Factory settings restoration	+ R	Restore factory settings

KM Switching in Single-Head Mode :

Conveniently and efficiently, Users are allowed to seamlessly switch between PCs by moving the mouse from one monitor to another.

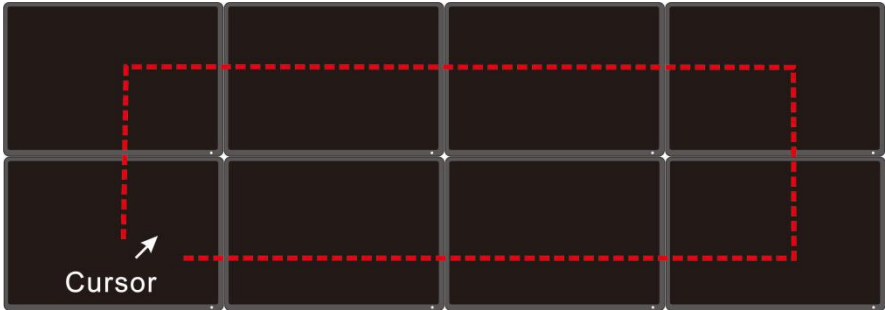

- KM0108 automatically switches when the mouse moves between screens.

KM Switching in Multi-Head Mode:

Users only need to double-click the scroll wheel in the middle of the mouse and move along the direction of the channel you want to switch to.

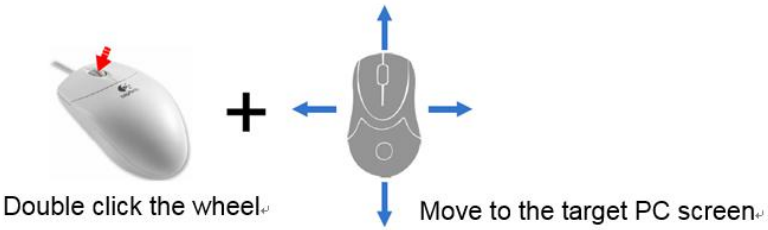

Under Multi-Head Mode, USB2.0 peripherals cannot be switched.

Specification

Function			KM0108
Computer Connections			8
Port selection			Pushbuttons, Hotkey, Mouse
Connectors	Console	Keyboard/Mouse	1 x double-layer USB type A
		Speaker (out)	1 x Min Stereo Audio Jack
	KM	Keyboard/Mouse	8 x USB type B
		Speaker (in)	8 x Min Stereo Audio Jack
	Power		1 x DC Socket
	USB2.0 Port		1 x double-layer USB type A
	LED OUT		1 x DB9 (Female)
	Upgrade Port		1 x USB-C Socket
Switch	Port selection		8 x buttons
Power			5V- 12V DC
Power Consumption			5W
Emulation	Keyboard/Mouse		USB
Environment	Operating Temperature		0-50°C
	Storage Temperature		-20-60°C
	Humidity		0-80%RH, Non-condensing
Physical Characteristics	Material		Metal
	Weight		1.1kg
	Dimension		260 mmx115.6 mm x44mm